

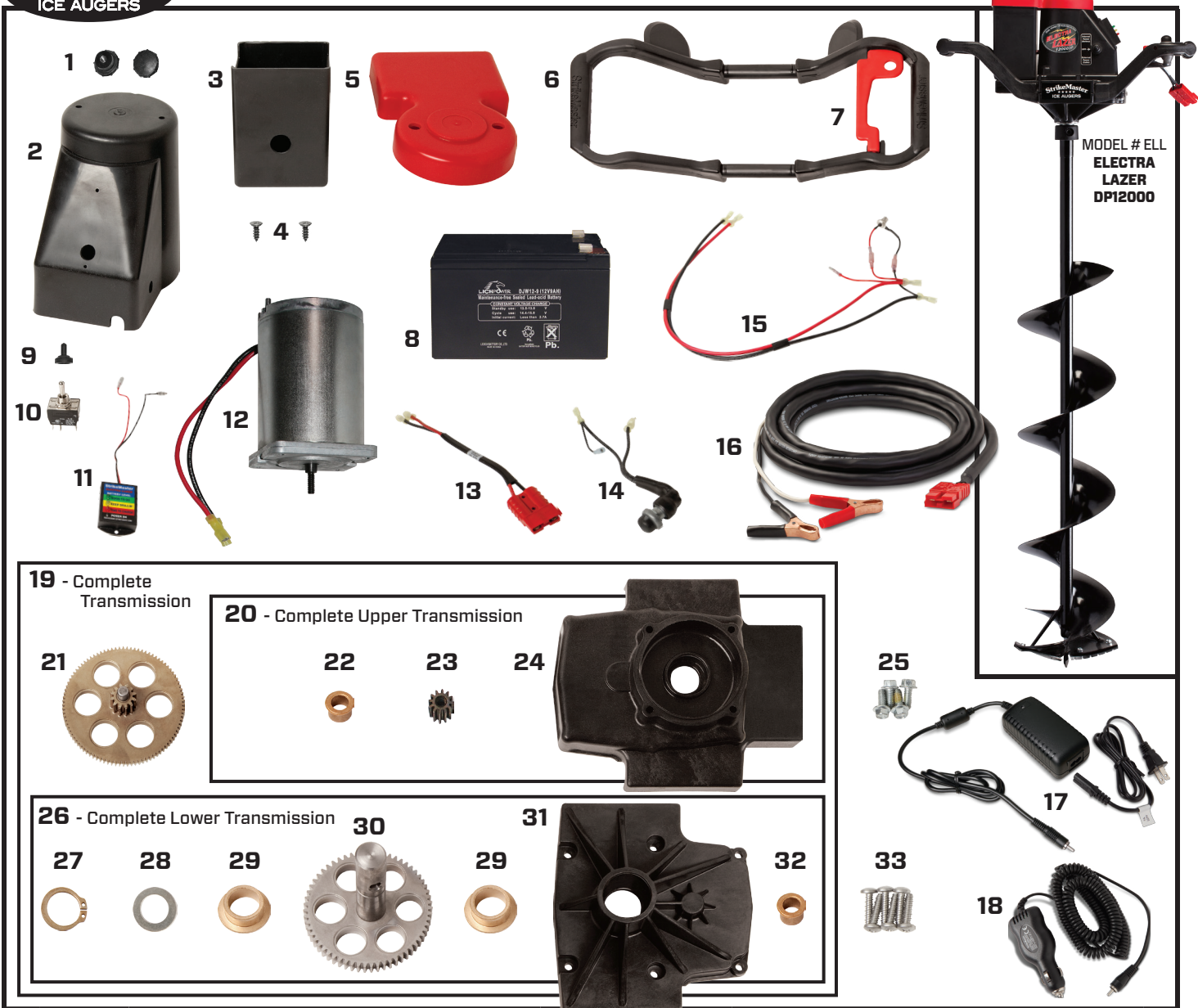

# ELL - ELECTRA LAZER DP12000 2013-Current Model Parts List



MODEL # ELL  
ELECTRA  
LAZER  
DP12000

#	Part No.	Description	Qty
1	151322	Battery Cover Knobs	2
2	151348	Electra Motor Cover	1
3	151312-09	Battery Box	1
4	410030	Battery Box Screws	2
5	151319-09	Motor/Battery Box	1
6	151388E	Composite Handle with Lever	1
7	151645E	Throttle Lever with Screw	1
8	ERB-1	12-volt/9-amp Battery Replacement	1
9	151318	Toggle Switch Boot	1
10	151317	Internal/External Toggle Switch	1
11	151310-09	Battery Meter	1
12	151438	ELL Motor	1
13	151320-09	Power Pole Assembly	1
14	151336-09	60-amp Push Button Switch Assembly	1
15	151315-09	DC Power Assembly with Charger Plug	1
16	151358	Power Cord with Battery Clamps	1
17	EBC-1	12-volt Battery Charger Plug-in (Wall Outlet Adapter)	1
18	ECC-2	1.0-amp Car Charger Plug-in	1

#	Part No.	Description	Qty
19	211S-U	Complete Transmission (Includes #20-Upper, 26-Lower & 21-Gear)	1
20	140 S-U	Complete Upper Transmission (Includes #22, 23 & 24)	1
21	211310	40:1 Compound Gear	1
22	122210	Flange Bushing Compound (Upper)	1
23	140320	40:1 Pinion Gear	1
24	211105	Transmission Case (Upper - must order #19 or 20)	1
25	470833	Upper Transmission Bolt - 1/4 - 20 x 5/8 HHFLGBLT with Nylon Patch	4
26	140 S-L	Complete Lower Transmission (Includes #27, 28, 29, 30, 31 & 32)	1
27	122920	Snap Ring Output Shaft	1
28	122915	Output Shaft Washer	1
29	122215	Flange Bushing Output Shaft	2
30	122305	Output Shaft with Drive Gear	1
31	122120	Transmission Case (Lower - must order #19 or 26)	1
32	122210	Flange Bushing Compound (Lower)	1
33	410011S	Lower Trans Screws Hi-Low Cut Philips	6

If your auger is still under warranty, please contact StrikeMaster Customer Service at [service@normarkcanada.com](mailto:service@normarkcanada.com). Please be advised, work performed outside of an authorized service center will void your StrikeMaster warranty. To purchase the parts listed, please contact one of our Canadian master service centers. SM10/14